



HYDAC Technology Corporation

2260 City Line Road,

Bethlehem, PA 18017

TOLL FREE: [877-GO-HYDAC](tel:877-GO-HYDAC) (464-9322)

Website: [www.hydac-na.com](http://www.hydac-na.com)

# VD: High Pressure Type J4: Electrical Switch

Early warning pressure devices protect the hydraulic circuit from contamination, alerting the operator that the filter element is near capacity and must be changed. The clogging indicator is typically set to trip at 1-bar (14 psid) below the filter bypass setting, to allow the operator sufficient time for element change-out. Available in visual, combo electrical/visual, as well as an extensive list of other options and certifications. A comprehensive offering of clogging indicators ensures that

[+ more](#)

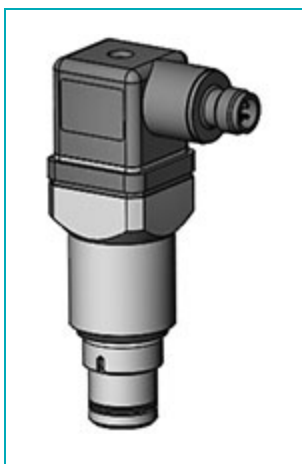

1

Part Number	Model Code Description	Type of Indication	Trip Pressure / Range	Operating Pressure [Max]	Thread	Medium	Maximum Torque
<a href="#">2097650</a>	VD2J4.1	Electrical Switch	2 bar 29 psi	420 bar 6000 psi	G 1/2	Mineral Oil	74 lb·ft 100 N·m
<a href="#">2078549</a>	VD2J4.1/ T100	Electrical Switch	2 bar 29 psi	420 bar 6000 psi	G 1/2	Mineral Oil	74 lb·ft 100 N·m
<a href="#">2074519</a>	VD5J4.1	Electrical Switch	5 bar 72 psi	420 bar 6000 psi	G 1/2	Mineral Oil	74 lb·ft 100 N·m

Part Number	Model Code Description	Type of Indication	Trip Pressure / Range	Operating Pressure [Max]	Thread	Medium	Maximum Torque
<u>2074524</u>	VD5J4.1/ V	Electrical Switch	5 bar 72 psi	420 bar 6000 psi	G 1/2	Mineral Oil	74 lb·ft 100 N·m
<u>2203461</u>	VD5J4.1/ V-T100	Electrical Switch	5 bar 72 psi	420 bar 6000 psi	G 1/2	Mineral Oil	74 lb·ft 100 N·m
<u>2075822</u>	VD5J4.1/ W	Electrical Switch	5 bar 72 psi	420 bar 6000 psi	G 1/2	Water Base	74 lb·ft 100 N·m
<u>2074522</u>	VD8J4.1	Electrical Switch	8 bar 116 psi	420 bar 6000 psi	G 1/2	Mineral Oil	74 lb·ft 100 N·m
<u>2074496</u>	VD8J4.1/ T100	Electrical Switch	8 bar 116 psi	420 bar 6000 psi	G 1/2	Mineral Oil	74 lb·ft 100 N·m
<u>2074526</u>	VD8J4.1/ V	Electrical Switch	8 bar 116 psi	420 bar 6000 psi	G 1/2	Mineral Oil	74 lb·ft 100 N·m